

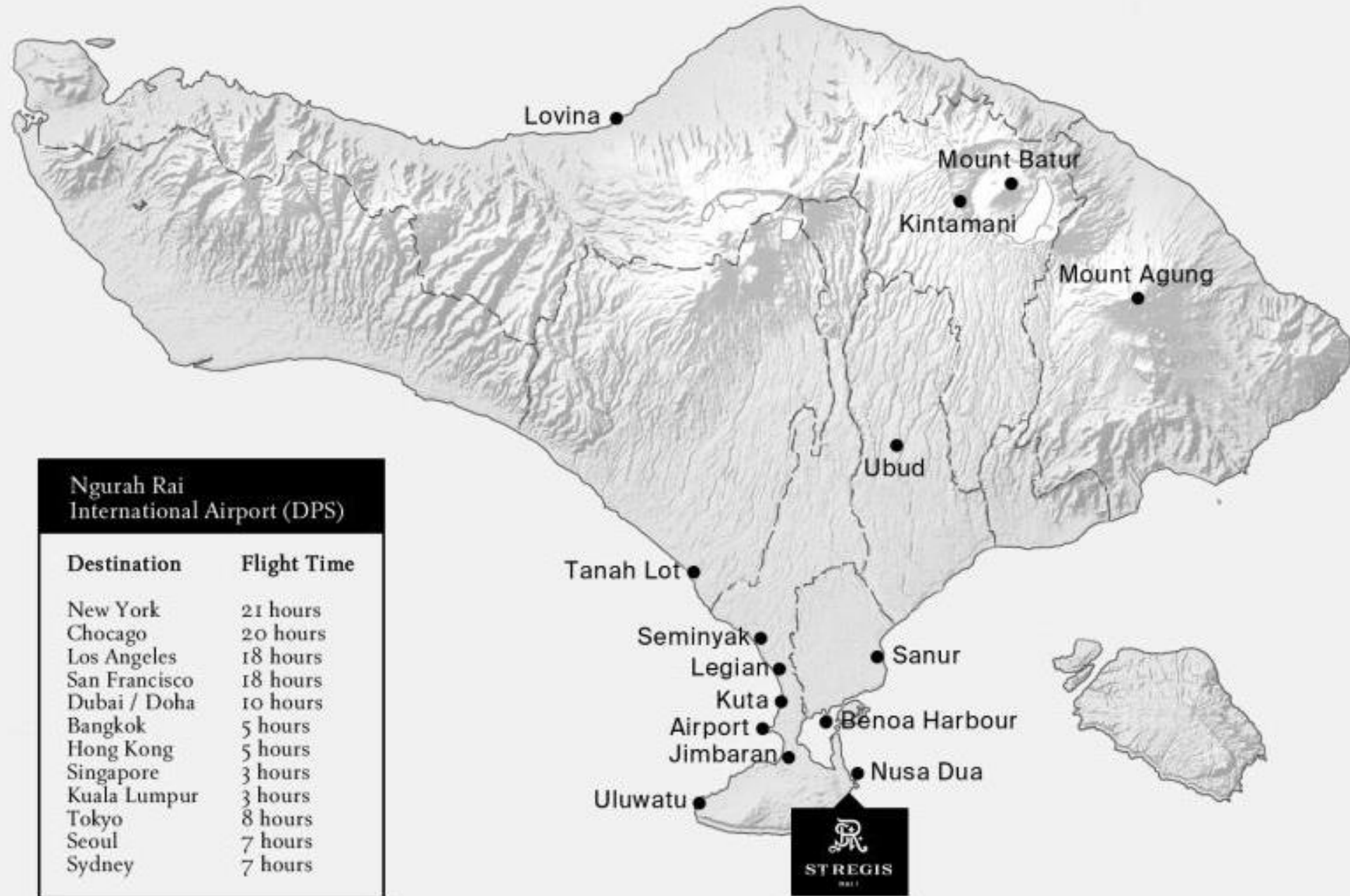

ST REGIS
BALI

Bali's Finest Address



Resort Map

AWARD-WINNING RESTAURANTS & BARS:

1. Kayuputi
2. Boneka
3. Gourmand Deli
4. Dulang
5. The St. Regis Bar
6. Vista Bar

RESORT FACILITIES:

- a. The St. Regis Spa
- b. Fitness Center
- c. Over 3,500 sqm of crystal blue saltwater lagoon and Children's Pool
- d. Children's Club
- e. Chef's Garden
- f. Amphitheatre

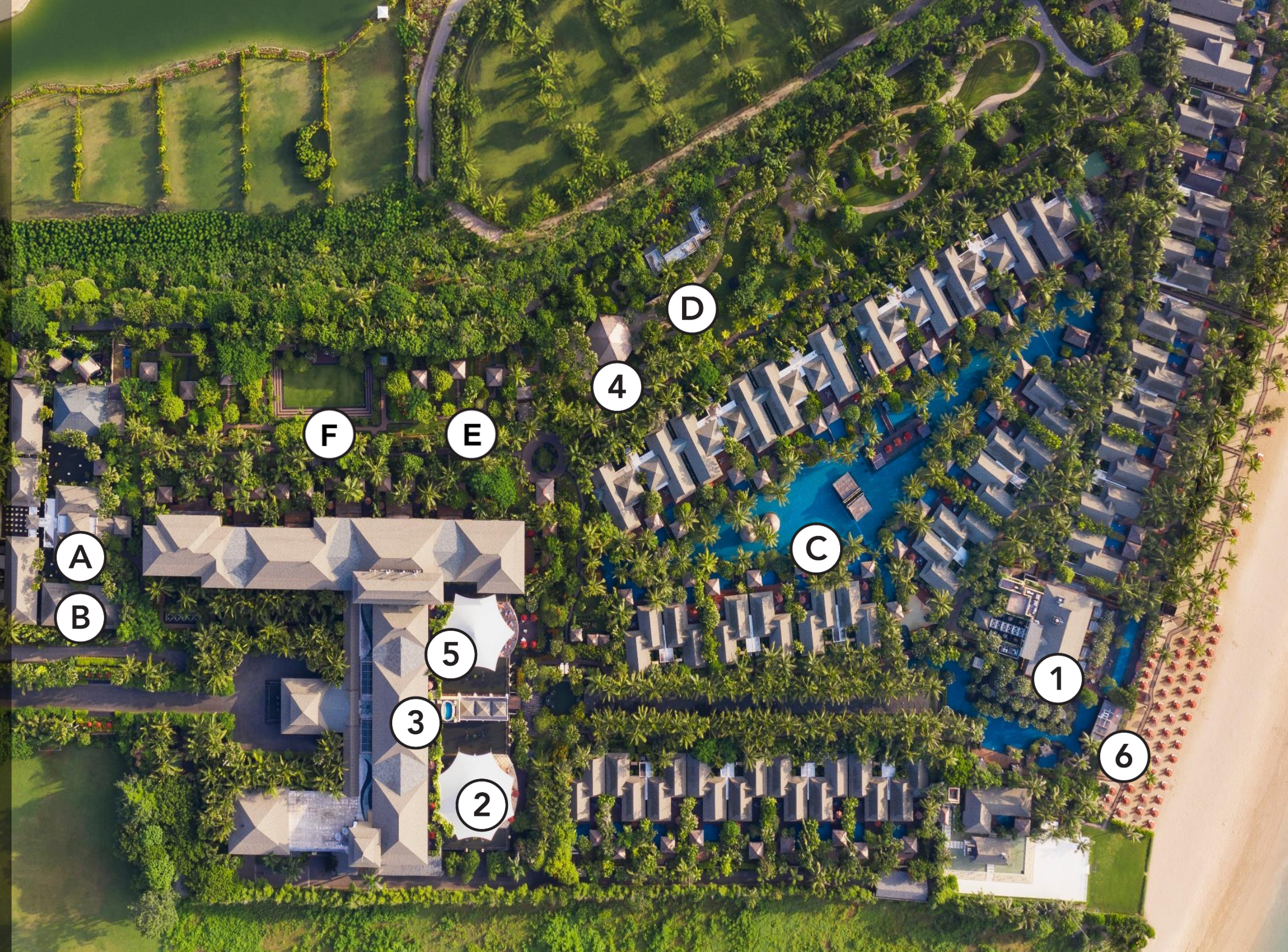

2026 Awards

ROBB REPORT BEST OF THE BEST 2026

- Paradise Reimagined, Pristine Beachfront Haven in Bali

TATLER BEST IN CLASS 2026

- Best 20 Hotels

DESTINASIAN READERS' CHOICE AWARD 2026

- #1 Indonesia Best Resort

CONDÉ NAST TRAVELLER 2025 READERS' CHOICE AWARDS

- #2 BEST RESORT IN INDONESIA – UK
- #4 BEST RESORT IN INDONESIA – US

TRAVEL + LEISURE 2025

- #24 – World's Best Awards
- Top 500 Hotels in the World

TRAVEL + LEISURE SEA 2025

- #5 – Best Beach Resort in Indonesia
- #6 – Best Hotel Spas in Indonesia – Iridium Spa
- #3 – Best General Manager in Indonesia – Hector Busto

WINE SPECTATOR RESTAURANT AWARDS 2025

- Kayuputi Restaurant - Best Award of Excellence



Design Concept

The St. Regis Bali Resort



Design Architect

The St. Regis Bali Resort was designed by Bill Bensley. The overall resort's design was inspired by the Balinese concept of "Nyegara Gunung" which describes a sacred journey from the mountain to the sea.





Accommodation:

81 Suites

41 Villas

2 Residences

Dining:

Kayuputi

Boneka

Gourmand Deli

Dulang

St. Regis Bar

Vista Bar

Facilities:

The St. Regis Spa

Amphitheatre

Bale Pantai

Children's Club

Chef's Garden

Over 3,500 sqm of saltwater
and freshwater lagoons

Room Categories

SUITES

<i>St. Regis Suite</i>	61
<i>St. Regis Ocean View Suite</i>	3
<i>Pool Villa Suite</i>	14
<i>Orchid Suite</i>	2
<i>Grande Astor Suite</i>	1

VILLAS (1 BEDROOM)

<i>Gardenia Villa</i>	9
<i>St. Regis Lagoon Villa</i>	11
<i>The Strand Villa</i>	10

VILLAS (2 BEDROOMS)

<i>St. Regis Lagoon Villa</i>	11
-------------------------------	----

VILLAS (3 & 4 BEDROOMS)

<i>The Strand Residence</i>	2
-----------------------------	---



St. Regis Suite



St. Regis Suite

Size: 92 sqm

Units: 64 (49 Kings, 12 Twins)



Pool Villa Suite



Pool Villa Suite

Size: 189 sqm

Units: 14 (11 Kings, 3 Twins)



Orchid Suite



Orchid Suite

Size: 237 sqm
Units: 2 (2 Kings)



Grand Astor Suite



Grand Astor Suite

Size: 518 sqm
Units: 1



Gardenia Villa



Gardenia Villa

Size: 411 sqm
Units: 9



1 Bedroom Lagoon Villa

Size: 371 sqm

Units: 11



1 Bedroom Lagoon Villa

Size: 371 sqm

Units: 11





2 Bedroom
Lagoon
Villa

Size: 436 sqm

Units: 11

2 Bedroom Lagoon Villa

Size: 436 sqm

Units: 11



An aerial photograph of a tropical villa complex. The image shows a large swimming pool with a curved edge, surrounded by numerous palm trees and other tropical vegetation. A sandy beach is visible on the right side, with the ocean waves breaking onto the shore. The villa buildings are partially visible on the left side. The overall scene is bright and sunny, with long shadows cast by the palm trees.

1 Bedroom Strand Villa

Size: 604 sqm

Units: 10

1 Bedroom Strand Villa



1 Bedroom Strand Villa

Size: 604 sqm

Units: 10



3-4 Bedroom Strand Residence



3-4 Bedroom Strand Residence



Strand Residence Level 1

Size: 966 sqm
Units: 2



Strand Residence Level 2

Size: 966 sqm

Units: 2



St. Regis Butler Service

Exceeding Expectations

The essence of St. Regis Butler Service is to offer guests discreet, personalized, and anticipatory attention down to the finest detail.



Signature Rituals

Afternoon Tea, Champagne Sabering, Bloody Mary and Evening Rituals, are the signature rituals inspired by the legacy of the Astor family brought to life.



Afternoon Tea



Champagne Sabrage



Bloody Mary



Evening Ritual

Evening Ritual

Champagne Sabrage

As twilight falls, we invite guests to its Evening Ritual, featuring the iconic Champagne Sabrage to mark the day's end.



Fire Dance

After the Sabrage, the Balinese Fire Dance showcases fire's symbolic power and honors Bali's rich heritage with rhythmic, awe-inspiring movements.





Exclusive Experiences with Direct Beach Access



Beachfront Yoga



Exquisite Sunrise Picnic



Coral Discovery

Award Winning Restaurants and Bars

Uninterrupted views of Nusa
Dua's spectacular beach offer
a dramatic backdrop for the
restaurants at The St. Regis
Bali Resort.





Chef Agung Ardiawan

With over 18 years of senior management experience in hotel kitchens across Bali and overseas, Chef Agung Ardiawan brings a wealth of expertise to his role as Director of Culinary. At the helm of the resort's culinary operations, he leads concept development, oversees menu innovation, and manages the resort's four award-winning dining venues and two iconic bars.

Kayuputi

As the resort's signature beachfront fine dining restaurant, Kayuputi offers an exceptional gastronomic experience. With sweeping views of the Indian Ocean, the restaurant presents a menu that blends contemporary flavors with local ingredients.



74 seats: 40 indoor, 34 outdoor, 20 mezzanine

Boneka

Inspired by the Indonesian word for "puppet," Boneka offers a refined take on continental fare, with a menu showcasing the freshest ingredients.



106 seats: 90 indoor, 16 outdoor

Dulang

Tucked within lush gardens, Dulang offers an enchanting experience with its traditional Indonesian Rijsttafel dinner, served under a charming gazebo.



Gourmand Deli

A delightful culinary haven, Gourmand Deli offers a selection of imported artisan foods, boutique coffees, and international wines. This casual yet sophisticated venue is perfect for a light meal or snack, with a menu that caters to those seeking gourmet delicacies.



40 seats - 26 outdoor, 14 indoor



The St. Regis Bar

Sophisticated and timeless, The St. Regis Bar offers a premier destination for classic cocktails and the renowned St. Regis Afternoon Tea.



60 seats - 32 outdoor, 28 indoor



Vista Bar

Perched along the beachfront, Vista Bar offers breathtaking views of the Indian Ocean, making it the perfect spot to enjoy a cocktail while admiring the magnificent sunset.



26 seats



The image shows a multi-level outdoor spa complex. In the foreground, there's a large, irregularly shaped hot tub with bubbling blue water. To its right is a smaller, circular hot tub. In the background, a stone waterfall cascades down a wall. The entire area is sheltered by a dark wooden frame with a thatched roof. Lush tropical plants and palm trees are visible in the background under a clear blue sky.

The St. Regis Spa

The St. Regis Spa



Spa Treatment Room





Children's Club

Children's Club



Infinity Salt Water Lagoon

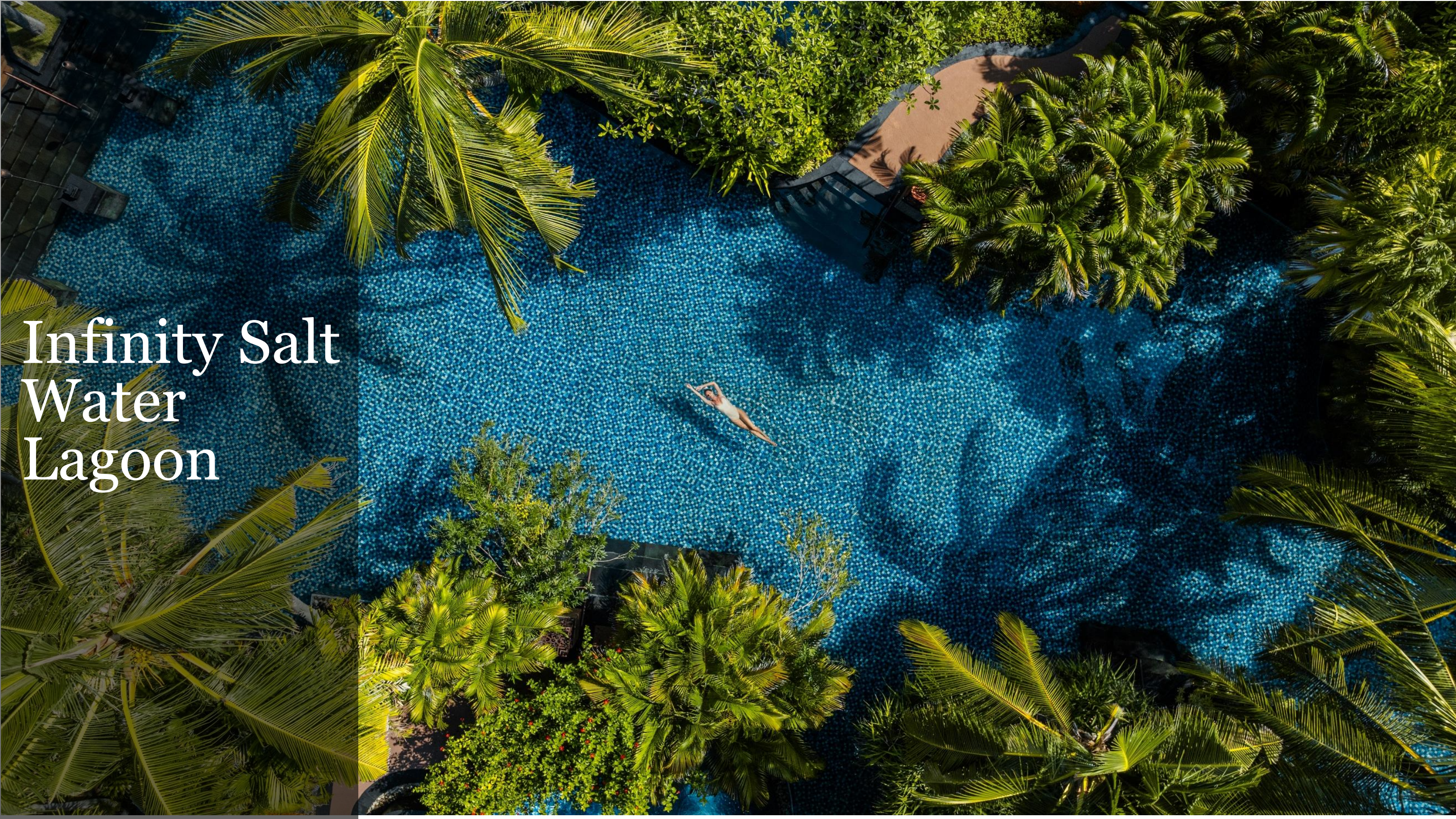



Direct
Beachfront
Location

Fresh Water Lagoon

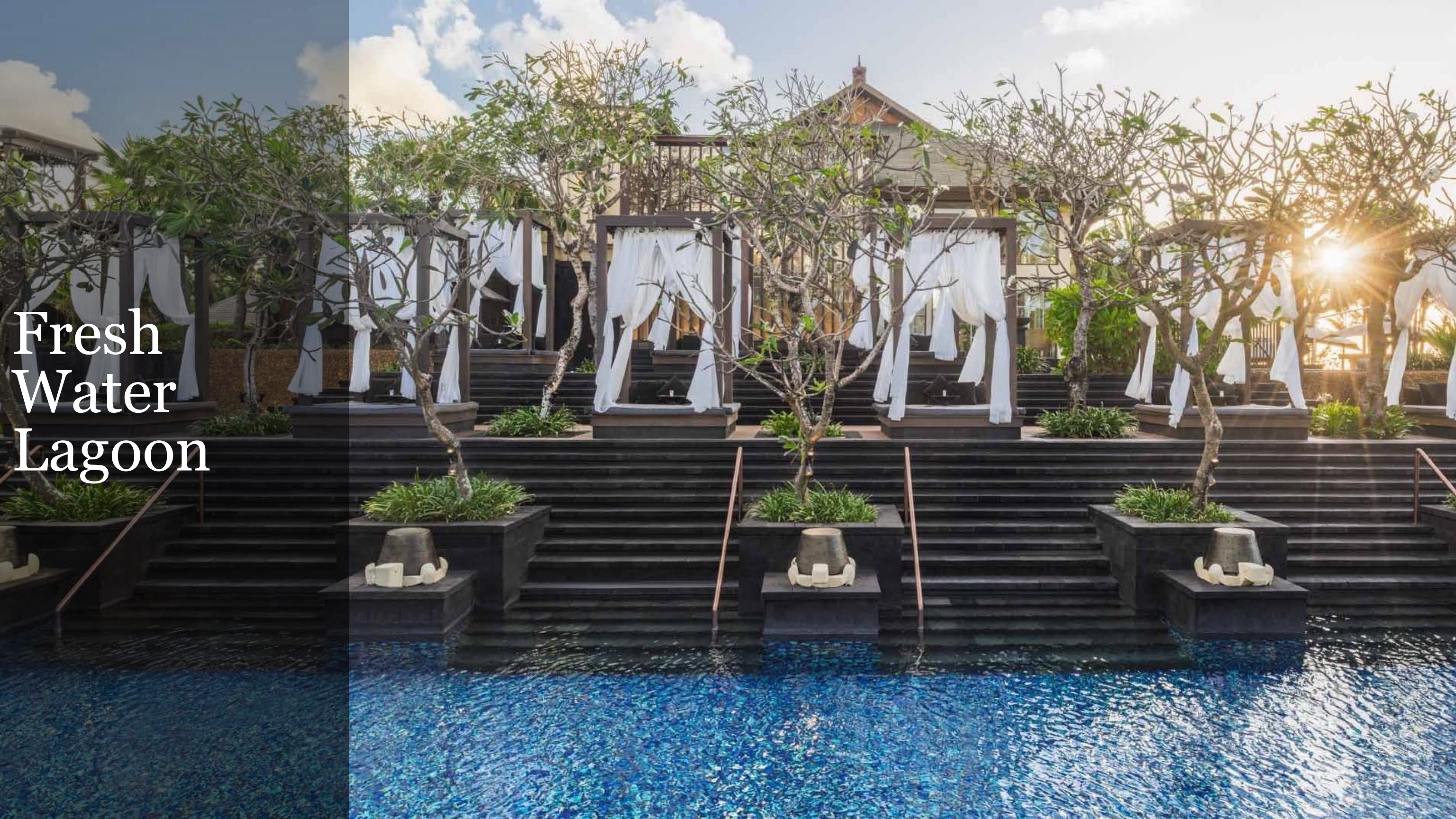

A romantic dinner table is set under a large tree with white orchids and candles. The table is covered with a white tablecloth and is set with white plates, silverware, and glassware. Several lit candles in glass holders provide a warm, ambient glow. The table is decorated with large arrangements of white orchids. The background is dark, making the white flowers and candles stand out. The overall atmosphere is elegant and intimate.

Meeting, Events & Weddings

Meeting Capacity

	DIMENSIONS (M)	TOTAL M ²	CEILING HEIGHT (M)	BANQUET	THEATER STYLE	BOARDROOM	CLASS	U-SHAPE	COCKTAIL
The Astor Ballroom	29 x 10	290	3.5	150	180	60	90	60	180
Astor A	18 x 10	180	3.5	80	140	30	54	30	140
Astor B	11 x 10	110	3.5	60	40	20	36	20	40
Astor Foyer	37 x 10	370	3.4	n/a	n/a	n/a	n/a	n/a	180
John Jacob IV	4.8 x 7.8	38	3.7	n/a	n/a	12	n/a	n/a	n/a
Newport	4.8 x 3.9	19	3.1	n/a	n/a	6	n/a	n/a	n/a
Amphitheatre	26 x 13	345	n/a	n/a	n/a	n/a	n/a	n/a	200
Cloud Nine Chapel	8.9 x 4.9	43	6.4	20	50	16	18	16	25
Cloud Nine Terrace	n/a	300.82	n/a	150	—	—	—	—	180

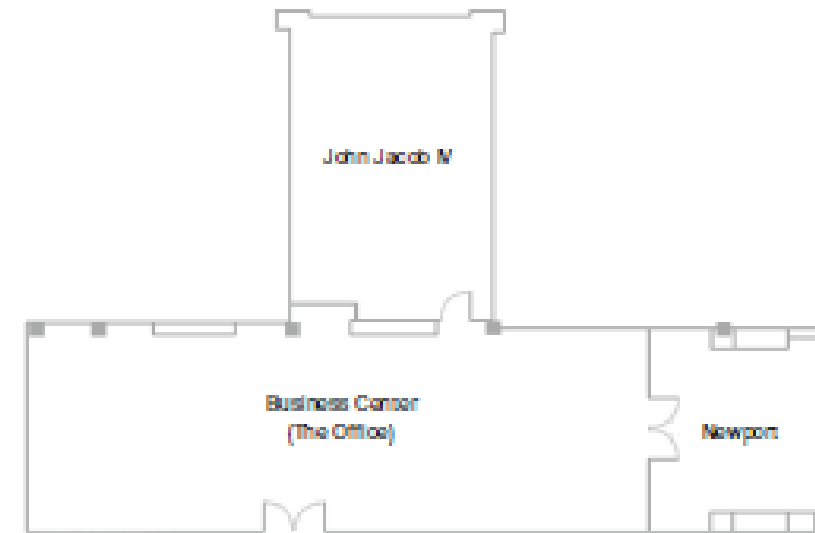

Lobby Level

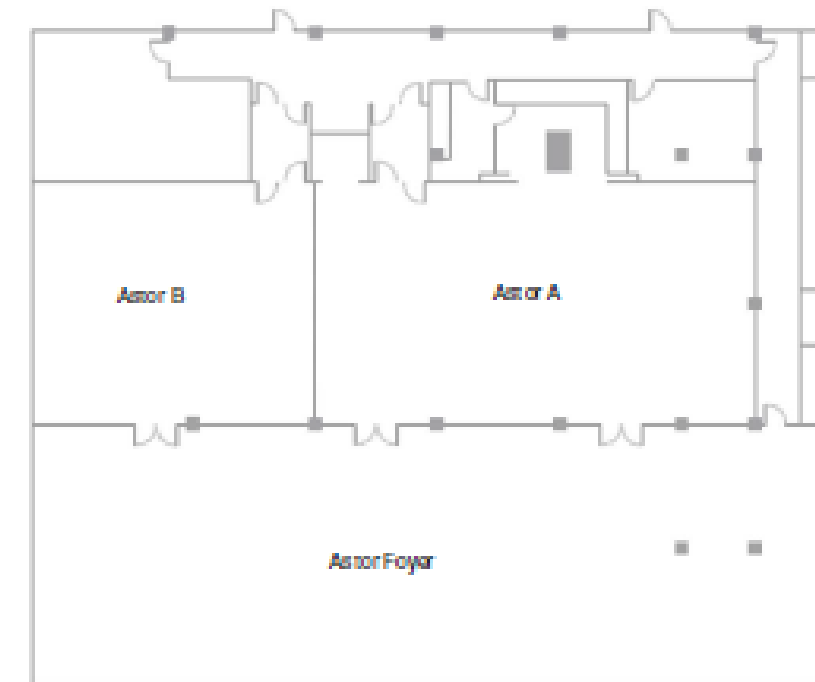

Ground Level

Astor Ballroom



	<u>Dimensions (LxWxH)</u>	<u>Area (sq.mt)</u>	<u>Theater</u>	<u>Schoolroom</u>	<u>Conference</u>	<u>U-Shape</u>	<u>Reception</u>	<u>Banquet</u>
Astor Ballroom	29x10x3.5	290	180	90	60	60	180	150

Astor Ballroom



Dimensions (LxWxH)

Area (sq.mt)

Theater

Schoolroom

Conference

U-Shape

Reception

Banquet

Astor Ballroom

29x10x3.5

290

180

90

60

60

180

150

Cloud Nine Chapel



Dimensions (LxWxH)

Area (sq.mt)

Theater

Schoolroom

Conference

U-Shape

Reception

Banquet

Cloud Nine Chapel

29.2x16.1x21

469.4

50

18

16

16

25

20

Cloud Nine Terrace



	<u>Dimensions (LxWxH)</u>	<u>Area (sq.mt)</u>	<u>Theater</u>	<u>Schoolroom</u>	<u>Conference</u>	<u>U-Shape</u>	<u>Reception</u>	<u>Banquet</u>
Cloud Nine Terrace	130.6x80.7x-	3229.2	-	-	-	-	180	150

Cloud Nine Terrace



Dimensions (LxWxH)

Area (sq.mt)

Theater

Schoolroom

Conference

U-Shape

Reception

Banquet

Cloud Nine Terrace

130.6x80.7x-

3229.2

-

-

-

-

180

150

Astor Ballroom Foyer



Dimensions (LxWxH)

Area (sq.mt)

Theater

Schoolroom

Conference

U-Shape

Reception

Banquet

Astor Ballroom Foyer

121.4x32.8x-

3982.7

-

-

-

-

80

-

John Jacob IV



Dimensions (LxWxH)

Area (sq.mt)

Theater

Schoolroom

Conference

U-Shape

Reception

Banquet

John Jacob IV

26.2x16.4x12.1

430.6

-

-

12

-

-

-

NEWPORT

Newport



Dimensions (LxWxH)

Area (sq.ft)

Theater

Schoolroom

Conference

U-Shape

Reception

Banquet

Newport

16.4x13.1x9.8

215.3

-

-

6

-

-

-

Wellness Activities



Sea Side Cycling



Pilates Mat Work by the Beach



Purification Ritual



Aqua Agility Boost



Yoga & Meditation



Herbal Hour



Canang Sari & Gebogan Making



Thank You

